

**Aufbauanleitung 03/2021**

**NOTWENDIGES WERKZEUG:**

Steckschlüssel/ Ratsche 13 mm für M8-Sechskantmutter

Führen Sie den Aufbau des Tisches **auf einer weichen Unterlage (z.B. einer Decke)** aus, um Beschädigungen zu vermeiden.

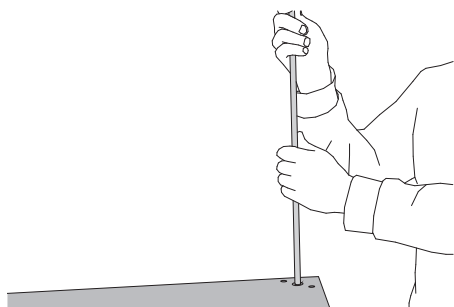

**1.** Die Tischplatte mit der Oberseite auf eine Decke o.ä. legen und die Gewindestange eindrehen.

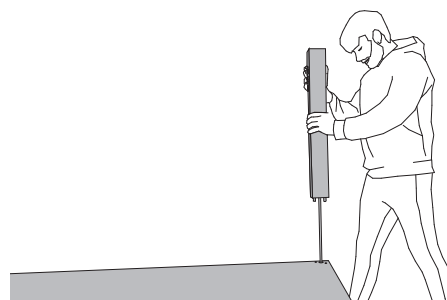

**2.** Fuß auf die Gewindestange setzen.

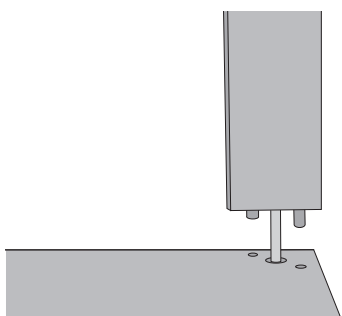

**3.** Die Dübel nach den Bohrungen ausrichten.

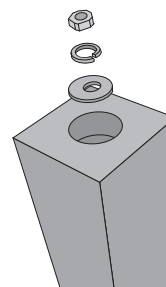

**4.** Beilagscheibe, Sprengring und Mutter aufsetzen.

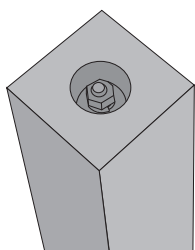

**5.** Die Mutter leicht andrehen.

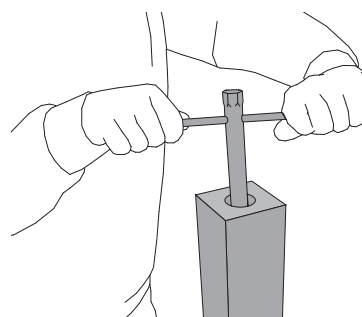

**6.** Mutter mit Steckschlüssel/ Ratsche anziehen.

**Assembly instructions 03/2021**

**TOOLS:**

socket wrench 13 mm for M8 hexagon nut

Please assemble the table **on a soft surface (e.g. a carpet or blanket)** to avoid damages.

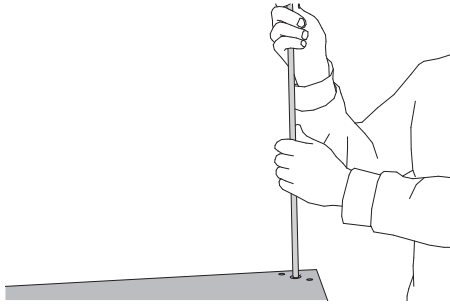

**1.** Place the table top upside down on a blanket and screw in the threaded rod.

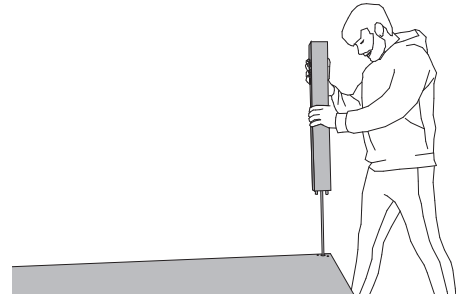

**2.** Place the table leg on the threaded rod.

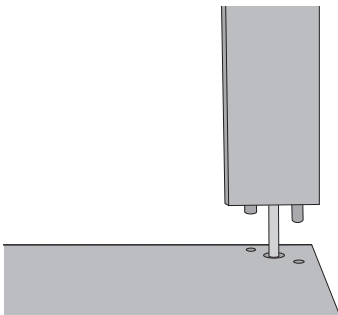

**3.** Place the leg on the table top and insert the dowel pins into the holes.

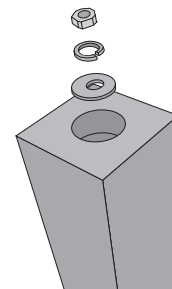

**4.** Place flat washer, spring washer and screw nut.

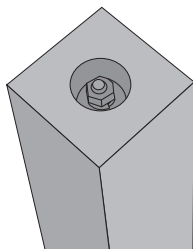

**5.** Screw in the screw nut.

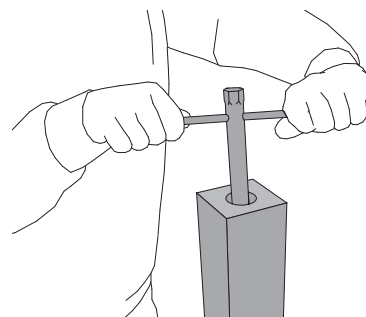

**6.** Tighten the screw nut using a socket wrench.